

**351105**
**BF 40P Gray**
**PT**

### Material Construction

Conveying Surface	Material	G Elastomer
	Profile	Normal Texture
	Color	Gray
Tension Member	Material	Nylon
	Plies	1
Underside	Material	G Elastomer
	Profile	Normal Texture
	Color	Gray

### Technical Specifications

Overall thickness	4.00 mm	0.157 in.
Weight	4.30 kg/m <sup>2</sup>	0.88 lbf/ft <sup>2</sup>
Maximum width	508 mm	20 in.
Minimum pulley/Back flex	40 mm	1.575 in.
Diameter for recommended endless splice		
Shaft Load FW at 1% Elongation & 180° Arc of Contact	10 N/mm	57.10 lbs./in.
Load for 1% Extension	5 N/mm	28.55 lbs./in.
Maximum Tensile Load	250 N/mm belt width	
Standard tension	1.5-3%	
Operational temperature range	-20/80°C	-4/176°F

### Features

FDA	NO	Anti-Static	YES
USDA Meat and Poultry	NO	Flame Retardant	NO
USDA Dairy	NO	Cross Rigid	YES
Anti-Microbial	NO		

### Standard Splices

Endless	Skived
Clipper Lace	Not Recommended
Staple Lace	Not Recommended

### Notes

Storage at normal temperature conditions of 23°C/73°F - 50% humidity recommended. Changes in the dimensions possible when conditions do not apply.  
Good damping properties.

\*Minimum pulley diameters can vary when mechanical lace is installed. Contact our technical team for any fabrication or application questions.

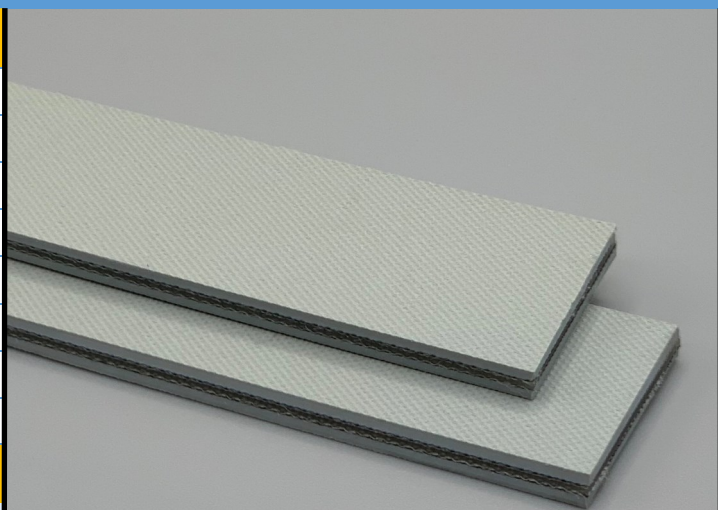

### Material Build

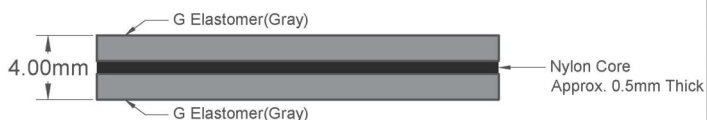

### Splicing Instructions

#### Standard Nylon Core Press Settings

Pressure (psi)	Temperature		Press Time	90° Grinding Length	60° Grinding Length
	Top	Bottom			
30	110°C 230°F	110°C 230°F	30 min	3.5"	4"
K2000 Adhesive on Polyamide Surface AF Adhesive for elastomer G (Rubber)				Silicone Release on top and bottom	

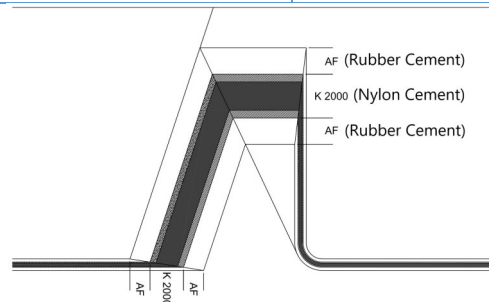

\*These settings are a guideline only, every press is different. Test splicing is recommended.

\*Minimum pulley diameters can vary when mechanical lace is installed. Contact our technical team for any fabrication or application questions.