

351115

BF 60P Gray

PT

Material Construction

Conveying Surface	Material	G Elastomer
	Profile	Normal Texture
	Color	Gray
Tension Member	Material	Nylon
	Plies	1
Underside	Material	G Elastomer
	Profile	Normal Texture
	Color	Gray

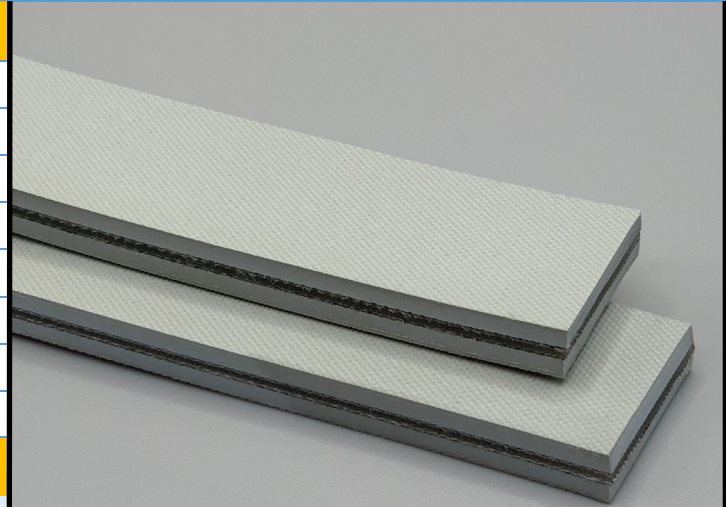

Technical Specifications

Overall thickness	6.00 mm	0.236 in.
Weight	6.80 kg/m ²	1.39 lbf/ft ²
Maximum width	508 mm	20 in.
Minimum pulley/Back flex	60 mm	2.362 in.
Diameter for recommended endless splice		
Shaft Load FW at 1% Elongation & 180° Arc of Contact	14 N/mm	79.94 lbs./in.
Load for 1% Extension	7 N/mm	39.97 lbs./in.
Maximum Tensile Load	350 N/mm belt width	
Standard tension	1.5-3%	
Operational temperature range	-20/80°C	-4/176°F

Material Build

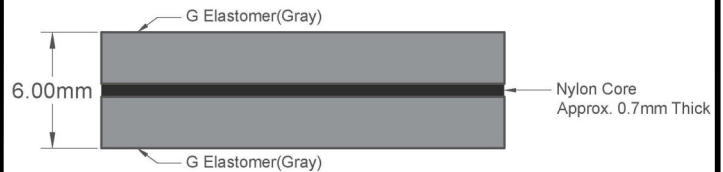

Features

FDA	NO	Anti-Static	YES
USDA Meat and Poultry	NO	Flame Retardant	NO
USDA Dairy	NO	Cross Rigid	YES
Anti-Microbial	NO		

Splicing Instructions

Standard Nylon Core Press Settings

Pressure (psi)	Temperature		Press Time	90° Grinding Length	60° Grinding Length
	Top	Bottom			
30	110°C 230°F	110°C 230°F	40 min	5.25"	6"
K2000 Adhesive on Polyamide Surface AF Adhesive for elastomer G (Rubber)				Silicone Release on top and bottom	

Standard Splices

Endless	Skived
Clipper Lace	Not Recommended
Staple Lace	Not Recommended

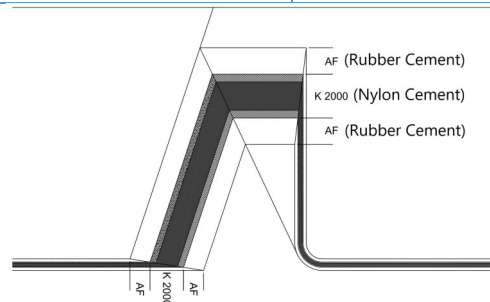

Notes

Storage at normal temperature conditions of 23°C/73°F - 50% humidity recommended. Changes in the dimensions possible when conditions do not apply.
Good damping properties.

*These settings are a guideline only, every press is different. Test splicing is recommended.

*Minimum pulley diameters can vary when mechanical lace is installed. Contact our technical team for any fabrication or application questions.

