

**351135**
**PT 21 P Green/Black**
**PT**

### Material Construction

Conveying Surface	Material	Highly Abrasion Resistant Rubber
	Profile	Super Fine Top Texture
	Color	Black
Tension Member	Material	Nylon
	Plies	1
Underside	Material	Highly Abrasion Resistant Rubber
	Profile	Fine Top Texture
	Color	Green



### Technical Specifications

Overall thickness	2.10 mm	0.083 in.
Weight	2.20 kg/m <sup>2</sup>	0.45 lbf/ft <sup>2</sup>
Maximum width	508 mm	20 in.
Minimum pulley/Back flex	30 mm	1.181 in.
Diameter for recommended endless splice		
Shaft Load FW at 1% Elongation & 180° Arc of Contact	15 N/mm	85.66 lbs./in.
Load for 1% Extension	7.5 N/mm	42.83 lbs./in.
Maximum Tensile Load	350 N/mm belt width	
Standard tension	1.5-3%	
Operational temperature range	-20/80°C	-4/176°F

### Features

FDA	NO	Anti-Static	YES
USDA Meat and Poultry	NO	Flame Retardant	NO
USDA Dairy	NO	Cross Rigid	YES
Anti-Microbial	NO		

### Standard Splices

Endless	Skived
Clipper Lace	Not Recommended
Staple Lace	Not Recommended

### Notes

Suitable for power transmission and spindle drives (black side = spindle side)  
 Storage at normal temperature conditions of 20°C/50% humidity recommended

\*Minimum pulley diameters can vary when mechanical lace is installed. Contact our technical team for any fabrication or application questions.

### Material Build



### Splicing Instructions

#### Standard Nylon Core Press Settings

Pressure (psi)	Temperature		Press Time	90° Grinding Length	60° Grinding Length
	Top	Bottom			
30	110°C 230°F	110°C 230°F	20 min	3.25"	3.25"

K2000 Adhesive on Polyamide Surface

AF Adhesive for elastomer G (Rubber)

Silicone Release on top and bottom

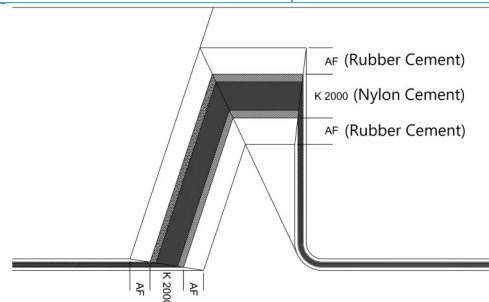

\*These settings are a guideline only, every press is different. Test splicing is recommended.

\*Minimum pulley diameters can vary when mechanical lace is installed. Contact our technical team for any fabrication or application questions.