

351136

PT 20 P Green/Green

PT

Material Construction

| | | | |
|-----------|-----------|----------|------------------|
| Surface | Conveying | Material | G Elastomer |
| | | Profile | Fine Top Texture |
| | | Color | Green |
| Member | Tension | Material | Nylon |
| | | Plies | 1 |
| Underside | | Material | G Elastomer |
| | | Profile | Fine Top Texture |
| | | Color | Green |

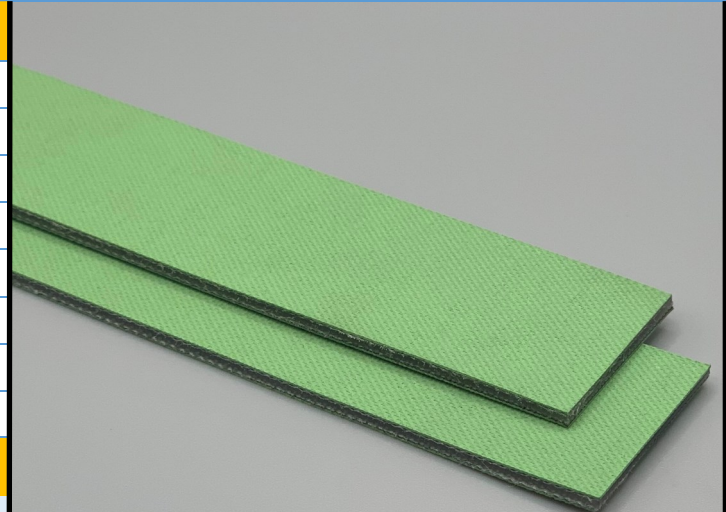

Technical Specifications

| | | |
|--|------------------------|--------------------------|
| Overall thickness | 2.00 mm | 0.079 in. |
| Weight | 2.10 kg/m ² | 0.43 lbf/ft ² |
| Maximum width | 508 mm | 20 in. |
| Minimum pulley/Back flex | 30 mm | 1.181 in. |
| Diameter for recommended endless splice | | |
| Shaft Load FW at 1% Elongation & 180° Arc of Contact | 14 N/mm | 79.94 lbs./in. |
| Load for 1% Extension | 7 N/mm | 39.97 lbs./in. |
| Maximum Tensile Load | 350 N/mm belt width | |
| Standard tension | 1.5-3% | |
| Operational temperature range | -20/80°C | -4/176°F |

Material Build

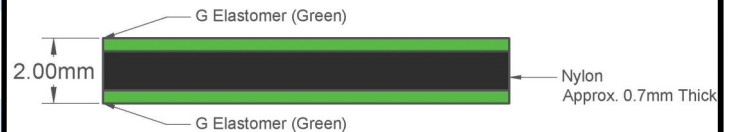

Features

| | | | |
|-----------------------|----|-----------------|-----|
| FDA | NO | Anti-Static | YES |
| USDA Meat and Poultry | NO | Flame Retardant | NO |
| USDA Dairy | NO | Cross Rigid | YES |
| Anti-Microbial | NO | | |

Standard Splices

| | |
|--------------|-----------------|
| Endless | Skived |
| Clipper Lace | Not Recommended |
| Staple Lace | Not Recommended |

Notes

Suitable for power transmission and spindle drives
Storage at normal temperature conditions of 20°C/50% humidity recommended

*Minimum pulley diameters can vary when mechanical lace is installed. Contact our technical team for any fabrication or application questions.

Splicing Instructions

Standard Nylon Core Press Settings

| Pressure (psi) | Temperature | | Press Time | 90° Grinding Length | 60° Grinding Length |
|----------------|----------------|----------------|------------|---------------------|---------------------|
| | Top | Bottom | | | |
| 30 | 110°C 230°F | 110°C 230°F | 20 min | 3.25" | 3.25" |

K2000 Adhesive on Polyamide Surface
AF Adhesive for elastomer G (Rubber)

Silicone Release on top and bottom

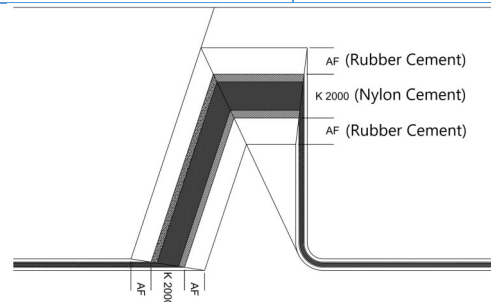

*These settings are a guideline only, every press is different. Test splicing is recommended.

*Minimum pulley diameters can vary when mechanical lace is installed. Contact our technical team for any fabrication or application questions.

